

Manual tape dispenser

Technical Data Sheet

The dispenser 161-21402 is a professional manual tape dispenser used for the sealing of cartons and packages. With its roller brake it is especially suitable for an easy tape dispensing. Two contact pressures allow an especially simple and smooth tape application. The tape cut-off is implemented by activating the release inside the handle, thus protecting the user from injuries.

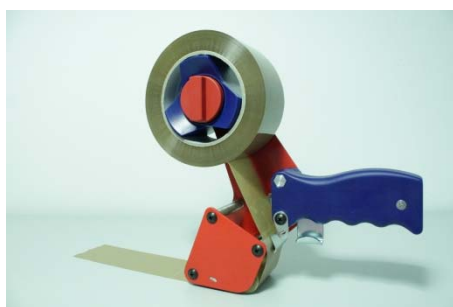

Tape Type	One sided adhesive tapes
Length	220 mm
Width	65 mm
Height	210 mm
Weight	520 g
Max. tape diameter	170 mm
Max. core diameter	3 inch = 76mm
Max. roll diameter	50 mm
Item / carton	1 piece
Item / dispatch unit	8 pieces



Blade protection

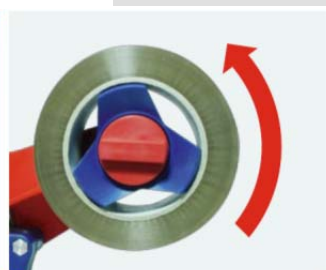

Roller brake



Double pressure rolls



Smart cut off

We give the technical data of our products, however non-committal, after the best knowledge.

Repair and spare part service information:

B&K Apparatebau KNECHT GmbH
tesa device Servicepartner
Neustrasse 19
DE-56348 Weisel

Tel.: +49 67 74 / 12 17
Fax: +49 67 74 / 14 38
service@tapedispenser.de

In case of questions on the device:

info@tapedispenser.de
www.tapedispenser.de
www.handabroller.info



Manual tape dispenser

Technical Data Sheet

Spare Part List

Spare Part Article No.	Spare Part Description
56402001	base plate
56402002	handle, completely with lever
56402003	cover plate
56402004	front contact pressure, completely with arbor and screws
56402004a	front contact pressure, alone
56402005	knife pillar completely with screws
56402006	zigzag knife
56402007	cover plate for knife
56402009	swivel frame, completely with contact pressure
56402010	tripping lever
56402011	tape threading path – roll, completely with arbor and screws
56402011a	synthetic bush alone (pair)
56402012	return stop with spring
56402013	leadingplate
56402014	tensionspring only for return stop
56402015	safety catch
56402016	arbor for safety catch, completely with screws and nut
56402017	rotary spring for safety catch
56402018	distance bar with screws
56402019	tension spring for swivel frame
56402021	screws with nut for grasp
56402022	bolt, completely with brake, arbor and screws
56402022k	recessed-head screw M5x10

We give the technical data of our products, however non-committal, after the best knowledge.

Repair and spare part service information:

B&K Apparatebau KNECHT GmbH
tesa device Servicepartner
Neustrasse 19
DE-56348 Weisel

Tel.: +49 67 74 / 12 17
Fax: +49 67 74 / 14 38
service@tapedispenser.de

In case of questions on the device:

info@tapedispenser.de
www.tapedispenser.de
www.handabroller.info



Manual tape dispenser

Technical Data Sheet

Exploded View Drawing

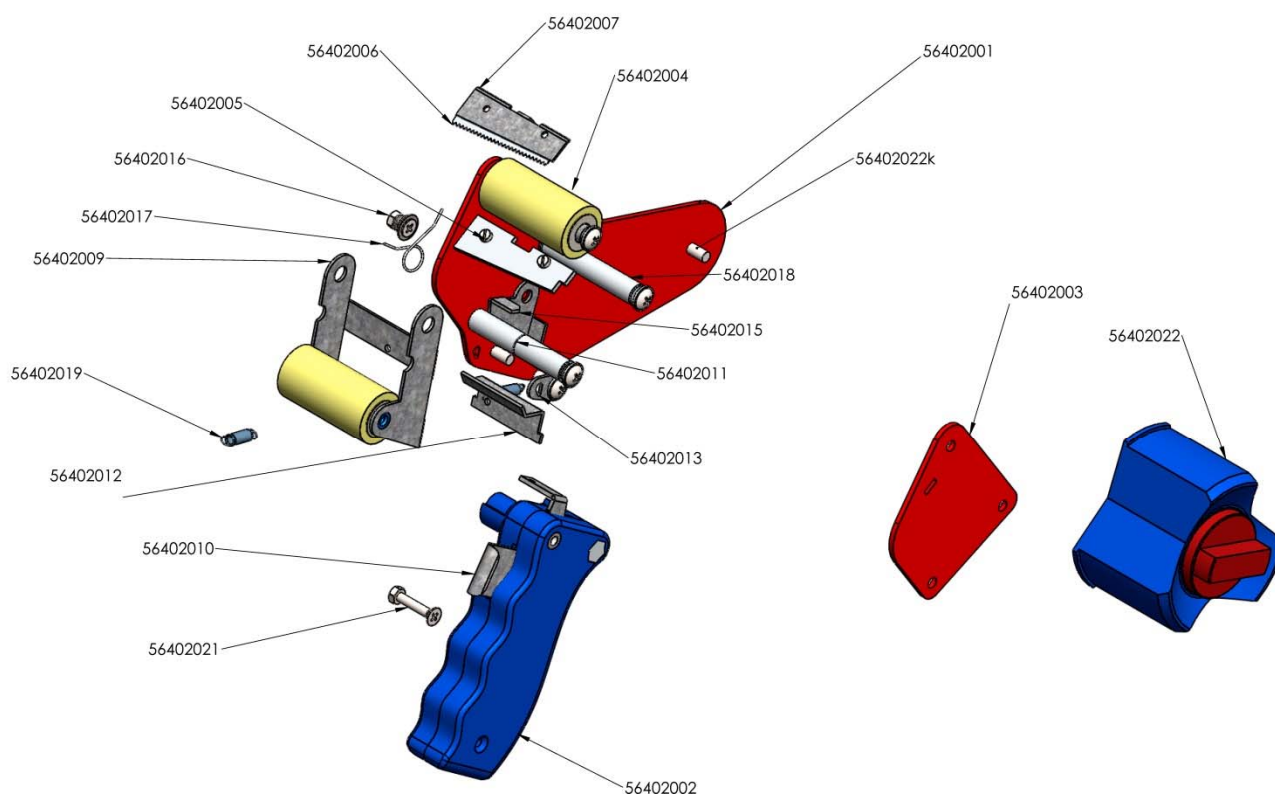

We give the technical data of our products, however non-committal, after the best knowledge.

Repair and spare part service information:

B&K Apparatebau KNECHT GmbH
tesa device Servicepartner
Neustrasse 19
DE-56348 Weisel

Tel.: +49 67 74 / 12 17
Fax: +49 67 74 / 14 38
service@tapedispenser.de

In case of questions on the device:

info@tapedispenser.de
www.tapedispenser.de
www.handabroller.info

